

Instruction Manual Perfect Lock PFR®-TSA ^{alpha}

Earthquake-proof latch
for hinged doors

Thank you for purchasing the Perfect Lock PFR-TSA ^{alpha}.
Thoroughly read all instructions and follow the manufacturer's guidelines before using latch.
Please store this instruction manual in safe place for future reference.

DISCLAIMER

- This product is sold or distributed with the understanding that user shall determine the suitability of such products for the intended use and shall assume all risk and liability.
- Unless otherwise specified, all products are designed to be used at a horizontal level.
Do not apply on a slope, it may cause poor performance.
- We are not responsible or liable for bodily injuries and/or property damage that may occur during the use of our products.
- In addition, we are not responsible or liable for any injuries or damage that result from a natural disaster or any act of God.
- We are not responsible or liable for improper use and/or installation of our products.
- Product may not be effective depending on the condition of the building construction or overload capacity.
- Fastening screws too tight may cause deformation.
- Please confirm product operation before using this product.
- Do not take product apart.
- For safety or technical purpose, product specification may change without notice.
- For detailed information not shown in this instruction manual, please contact our local agent.
- "PFR" is Murakoshi's registered trademark.
- All rights reserved by MURAKOSHI MFG. CORP. Duplication or transfer from this instruction manual without agreement is prohibited.
- Trademark, Design Right, Patent, and Practical Models are all registered.
- If you find any item that does not belong in this instruction manual, please notify us via email.

Package Contents

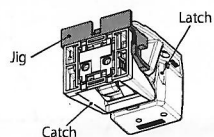

2 sets

Screws for Latches
8 Special Phillips
Binding Screws :
Size #6 x 0.55" L

※Screws for 2 latches are included in 1 bag.

8 installation screws for the latch

Screws for Catches
4 Binding Screws :
Size #6 x 0.63" L

※Screws for 2 catches are included in 1 bag.

4 installation screws for the catch

Mounting Positioning Check

$$[A] + [B] = 1.38" \pm 0.02"$$

[B] refers to the thickness of the cabinet door bumper.
In the case of no bumper, [B] will be 0".

Top View

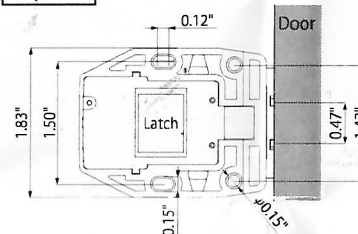

※Plastic part of catch must be slid down when you mount them.

Side View

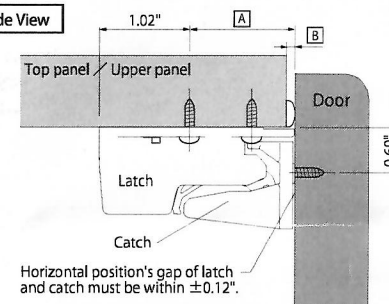

Horizontal position's gap of latch and catch must be within $\pm 0.12"$.

Mounting conditions

①The furniture must be level.

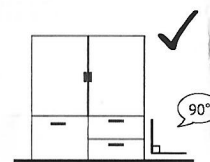

②Top panel must be not curved.



③The mounting points on the door and cabinet must be wooden.
The top and door panel cannot be too thin.

※This product cannot be affixed to glass, metal, etc.

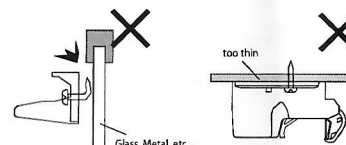

④Door's width must be 7.1" or more.
Door's height must be less than 35.0".
※Latch position must be on edge of door.

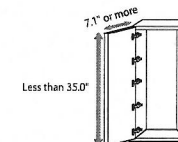

⑤The door must be outset type not inset type.
※You cannot use this product for inset type door.

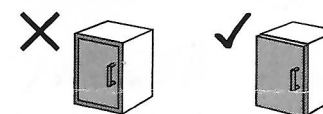

⑥The concealed hinge with catch must be correctly adjusted.

※You cannot use this product for "push-open" doors.

※You cannot use this product with concealed hinge without catch.

※Concealed hinge with catch: Concealed hinges with a built-in spring that closes the door automatically when the door is near to being closed.

※Push-open: Furniture with a door that opens when pushed.

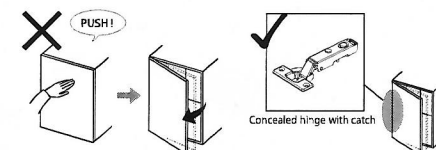

Preparation Before Installation

Extra tools required

- Screwdriver #2 Phillips
- Pencil
- Drill
- Ruler
- center punch

For double doors only,
mark on the door.

※Not necessary for Single door.

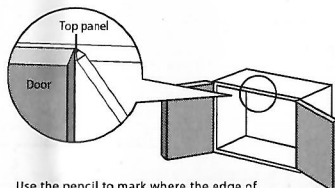
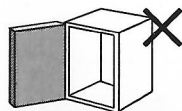

Use the pencil to mark where the edge of the door comes to (in the center of the cabinet).



Mounting Instructions

1 Positioning the Latch

For Double doors

Align the jig with the front of the top panel, leaving 0.8" of space between the jig and the mark made from the "Preparation Before Installation" step so you have enough space to use the screwdriver.

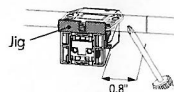

For Single doors

Align the jig with the front of the top panel, leaving 0.8" of space between the jig and side panel so you have enough space to use the screwdriver.

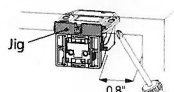

If the cabinet has bumpers

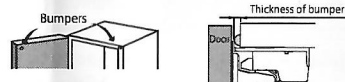

Make allowance for the bumper(※1), cushion(※2) or gasket (※3) when affixing.

- ※1 Bumper= A pad used to protect the wood while reducing the noise level of closing doors.
- ※2 Cushion= A pad used as a buffer. Attached to either the door or cabinet.
- ※3 Gasket= A seal attached to the cabinet to prevent dirt and other particulates from entering.

2 Temporarily affix the latch

Clean dust from the top panel where the latch will be placed.
Peel off the adhesive backing on the latch's double-sided tape.
Align the latch as instructed in step 1 and press firmly into place on the top panel to affix.

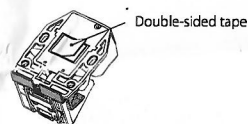

3 Affix the Latch

Make pilot holes at the center of the 2 oval-shaped holes using a center punch and then a drill.
Affix the latch using 2 of the included special Phillips binding screws for the latch and a screwdriver.
※Do not over-tighten screws, latch position may require necessary adjustments at step 7.

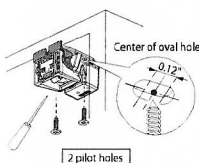

4 Positioning the Catch

Peel off the adhesive backing of the double-sided tape on the catch and close the door.
The catch will stick to the back side of the door.

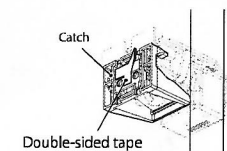

5 Affix the Catch

Open the door and make pilot holes to fasten the catch using a center punch and then a drill.
Affix using 2 of the included binding screws for the catch and a screwdriver.
Peel off the tape on the catch.

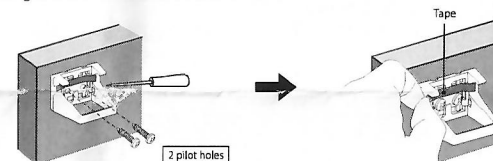

6 Remove the Jig

Remove the jig and the red tag.

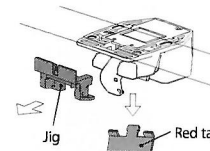

7 Confirm Operation

- When the door is fully closed the latch will lower. When the door is opened the latch will rise.
- Open and close the door several times to confirm operation of latch.

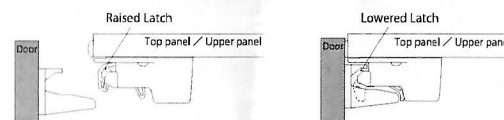

Necessary Adjustments

If the door will not close, reposition the latch by sliding the latch deeper inside the furniture.
※The latch can move back and forth because of oval screw holes.

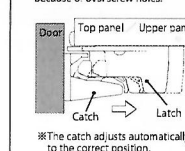

8 Final Step: Secure the Latch

Make pilot holes with a center punch and a drill for the round holes at the front of the latch.
Affix using the 2 included special Phillips binding screws for the latch and a screwdriver.

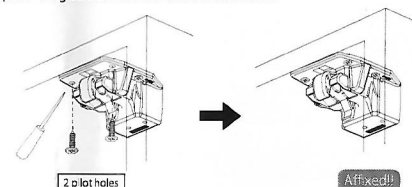

MURAKOSH